



HAWTHORN
UNIVERSITY OF THE THIRD AGE

TV | DVD | SOUNDBAR

User Guide

v.3

Updated July 2018: change of HDMI port allocations

Table of Contents

TV	- 3 -
The Remote.....	- 3 -
Choosing Screen Content.....	- 4 -
Using Source Button	- 4 -
SOUNDBAR.....	- 5 -
Turning On	- 5 -
Troubleshooting.....	- 6 -
Changing the Soundbar Effect	- 7 -
DVD	- 8 -
Turning On	- 8 -
Playing Content.....	- 9 -
Playing Content from a USB Stick	- 9 -
Using Smart Hub	- 10 -
To Show Content from Windows Laptop on TV	- 11 -
Physical Connection	- 11 -
Change the Display Mode on Laptop to Duplicate Content on TV Screen	- 12 -
Connect Apple Mac to TV	- 13 -
SUMMARY - Checklist Steps to play an Audio CD or Video DVD	- 17 -
SUMMARY - Checklist Steps to Display Laptop Content.....	- 18 -

TV

The Remote



Source/ Input button

(use to select between TV, DVD, PC etc)

On/Off Button

Smart Hub/ Home Button

This takes you to the Home menu.
Another option to change the source, or select Internet content if available.

Ok / Enter / Select button

Depress to select a displayed option.

Navigational Arrows

Click North, East, South, West areas to navigate.

Choosing Screen Content

Using Source Button

Choosing the Source button on the remote (see fig.1) reveals the following menu. Use Navigational arrows (see Fig.1) to move to desired source as follows:

HDMI1 – laptop connected via HDMI

HDMI2 – laptop connected via VGA

HDMI3 – BluRay/ DVD/ CD Player



Fig.2

SOUNDBAR

Turning On

Press the On/Off button on the remote (Fig.3) or on the unit itself (Fig.4) as shown below. The Soundbar should recognise the correct Source (DVD, PC etc) and configure itself accordingly and be ready to play.



Fig.3



Fig. 4

Troubleshooting



Fig. 5

If the Soundbar does not appear to be working, check the Source is correct by pressing the source button on the remote (Fig.5) or sidebar (Fig. 4) until the desired Source (DVD, PC, TV etc) shows on the Soundbar's display as shown below in Fig 6.



Fig.6

Check also that you have increased the Volume sufficiently on the Soundbar Remote.

Changing the Soundbar Effect

The Effect or Tone and quality of the Soundbar can be altered to best suit particular requirements. Adjust the Effect using the Sound Effect button shown in Fig. 7 below. Keep pressing the Sound Effect button and watch the display shown at Figure 8 to see which effect is selected (Clear Voice, Movie, Music etc).



Fig. 7



Fig. 8

DVD

Turning On

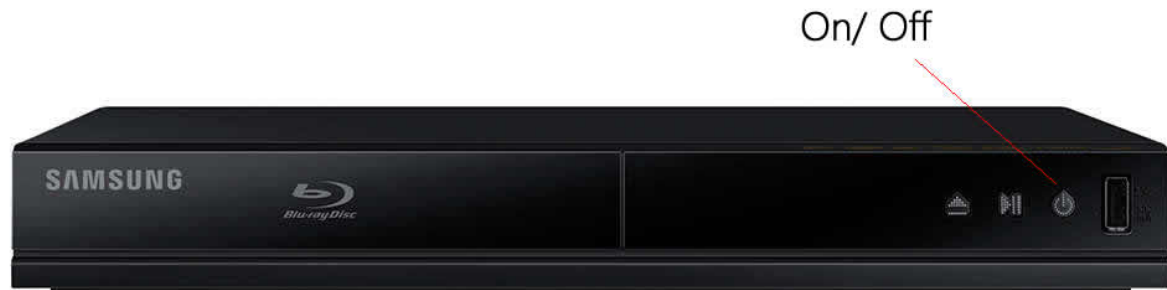

Alternatively, use On/Off switch on the remote's left hand side as shown below Fig.9.



Do not confuse DVD Player On/Off with the remote's capability to also adjust the TV On/ Off and other functions, in the boxed area on the right hand side of the DVD remote.

Fig. 9

Playing Content

Once the DVD player has been turned on, the TV screen should default to the DVD Home as per Fig. 10 below:



Fig 10.

(If you don't see the DVD Home screen, press the Source button on the TV Remote and choose select HDMI1. Alternatively use the Source button in the boxed section of the DVD remote, and change the TV screen source to HDMI1 (DVD).)

Choose Play disc for DVD/BluRay if the disc, once inserted, does not auto-play as it should.

Playing Content from a USB Stick

Connect your USB stick to the USB port on the front of the DVD player. Navigate to the DVD Player Home Screen as per above. Choose Videos rather than Play Disc as per Fig.10.

Using Smart Hub

The Smart Hub button takes you to the Home Screen or 'Smart Hub', example below:

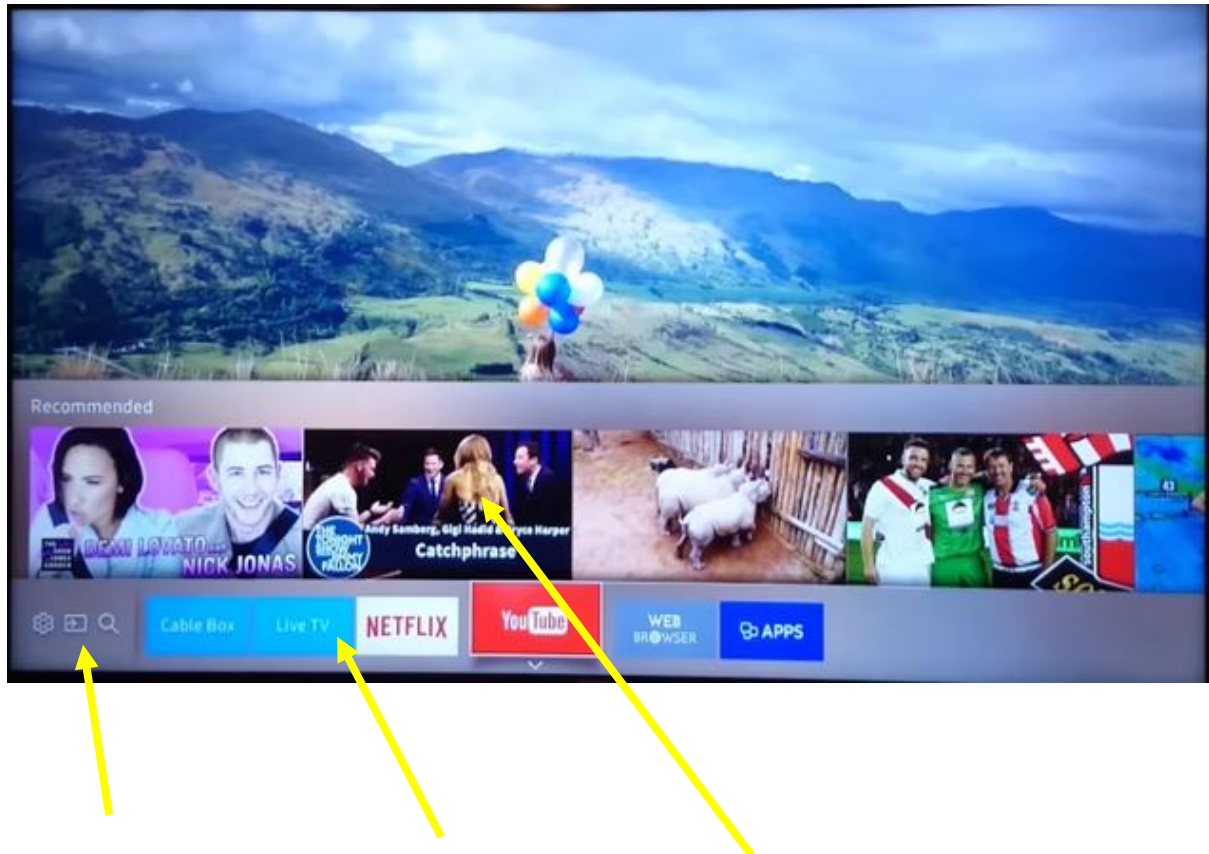

Source Button | Main menu | Context Menu

Use the Navigational Wheel Fig. 1 to move around the Main menu. The Context Menu will change depending on the Main Menu selection. For example, if you choose Live TV in Main Menu, the Context Menu will give you channels to choose from.

You may use the Source Button icon shown here to choose content from peripheral devices connected to the TV, for example the DVD player, or a laptop, or play online content from an app such as Youtube. But note that there may be insufficient bandwidth to stream Youtube clips and U3A encourages tutors to download content offsite and play at the venue via a laptop.

To Show Content from Windows Laptop on TV

To show content from a Windows laptop on the TV, you must first physically connect the laptop to the TV and secondly configure the laptop's display mode. Both requirements are addressed below:

Physical Connection

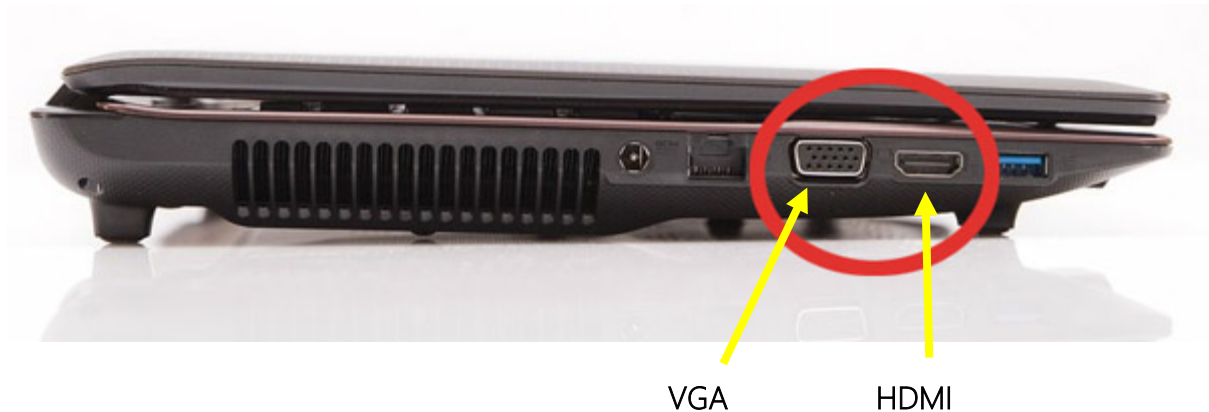

Note the Video connections that may be available from your laptop above. (DO NOT confuse the HDMI connection with a USB connection, which also shows in the diagram above directly to the right of the HDMI port.)

HDMI is the preferred connection if available. Connect your device to the cables below the TV according to the notations below. If using VGA, you must also connect your laptop's sound output to the input cable shown below. This is not required if using HDMI.

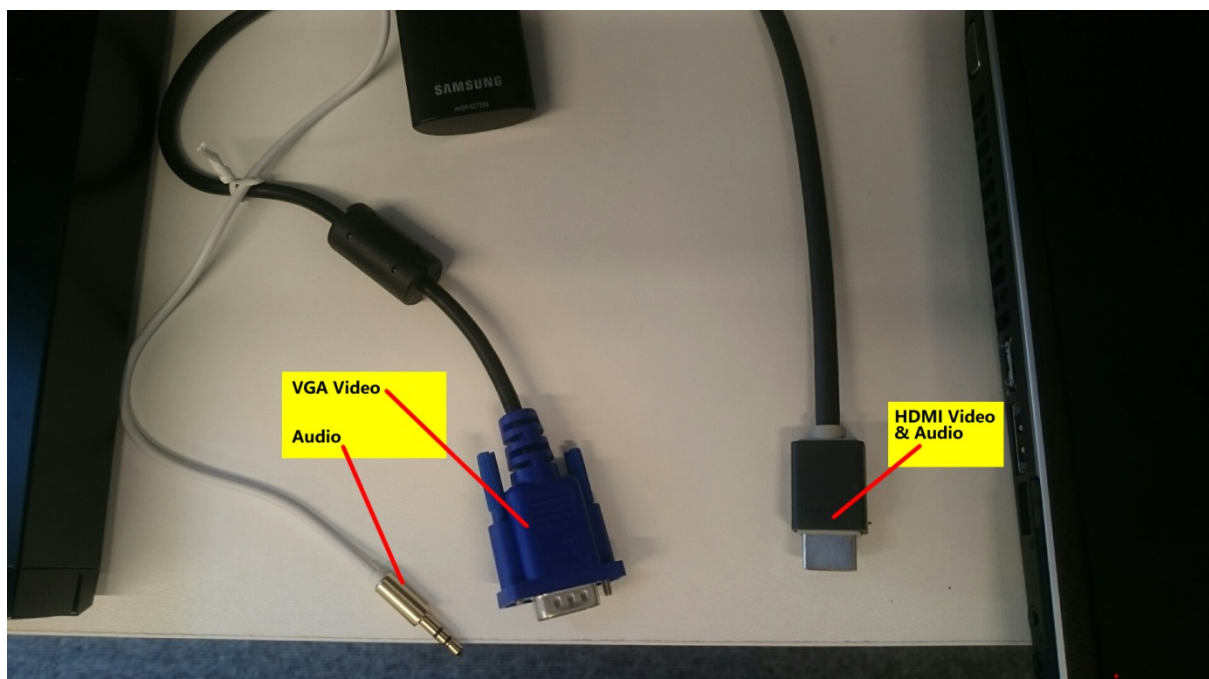

Set the TV Source to HDMI 2 for VGA or HDMI 3 for HDMI (refer pages 3 & 4 of this guide).

Change the Display Mode on Laptop to Duplicate Content on TV Screen

For Windows 7 and higher

1. To activate/de-activate a secondary display device, use the keyboard shortcut keys



2. On the box that appears use the keyboard's left or right arrow keys or the mouse to make a selection:

Select **Duplicate** to display the same content (mirror) on both your laptop and the data projector screen.

For Operating systems before Windows 7

Consult the chart below to see which F key command you need to press in order to get to the duplicate display mode.

1. Press and hold down the function key (Fn) and the appropriate F key (F1-F12). A dialog box will appear and displays the modes.
2. To get to the desired mode (Duplicate), continue pressing the appropriate Fn+F key as per your laptop model (see chart below). There is a delay of 5 seconds between the various modes available. Again, select Duplicate.

Computer Manufacturer	Key Command to Toggle Display Mode
ACER	fn-F5
ASUS	fn-F5
COMPAQ	fn-F4
DELL	fn-F8
FUJITSU	fn-F10
HP	fn-F4
IBM-LENOVO	fn-F7

SAMSUNG	fn-F4
SONY	fn-F7
TOSHIBA	fn-F5

Connect Apple Mac to TV

To connect Apple Macbooks to the Samsung TV's HDMI input tutors are required to supply their own converter. Fig.11 below shows and example of an Apple Mini-display to HDMI



Fig. 11

Connect the smaller, male end to your Mac and the HDMI cable that is attached to the patch panel below the TV to the female end of the converter.

Press the Source button on the TV remote and select HDMI3 connection as shown on pages 3 & 4 of this guide.

Troubleshooting

If the Mac's display does not show on the screen after correctly selecting the appropriate HDMI port as the TV's source, you may follow the guidance below to configure the Macbook.

Click the Apple logo, top right as shown in Fig. 12



Fig.12

Select System Preferences as per Fig 13.

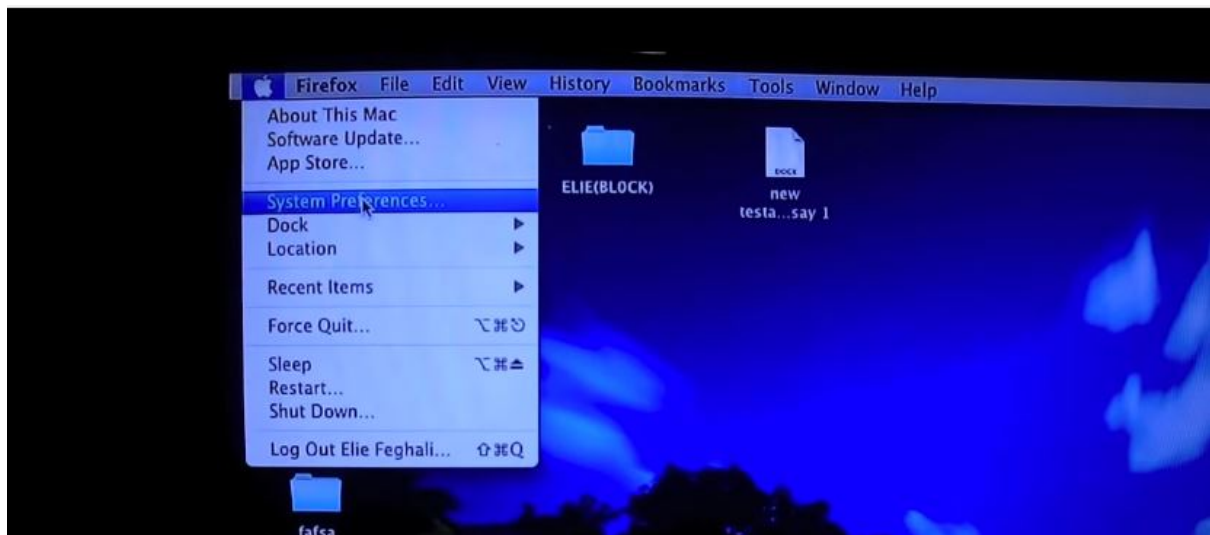

Fig. 13

Select Displays as per Fig. 14

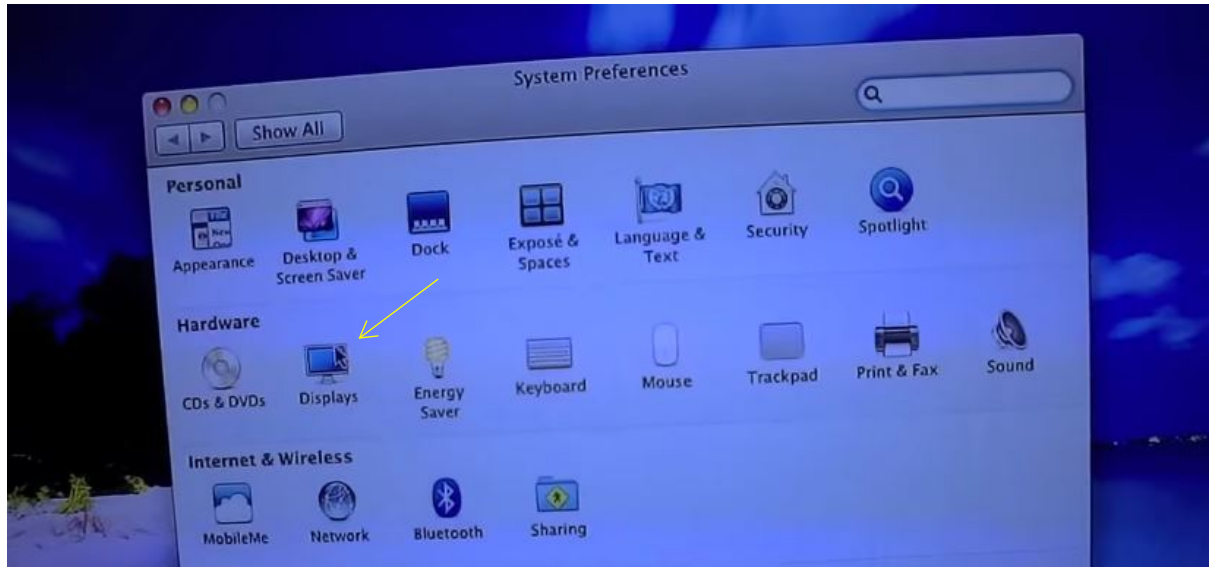

Fig 14

Select the Arrangement tab, and check the Mirror Displays box as per Fig. 15

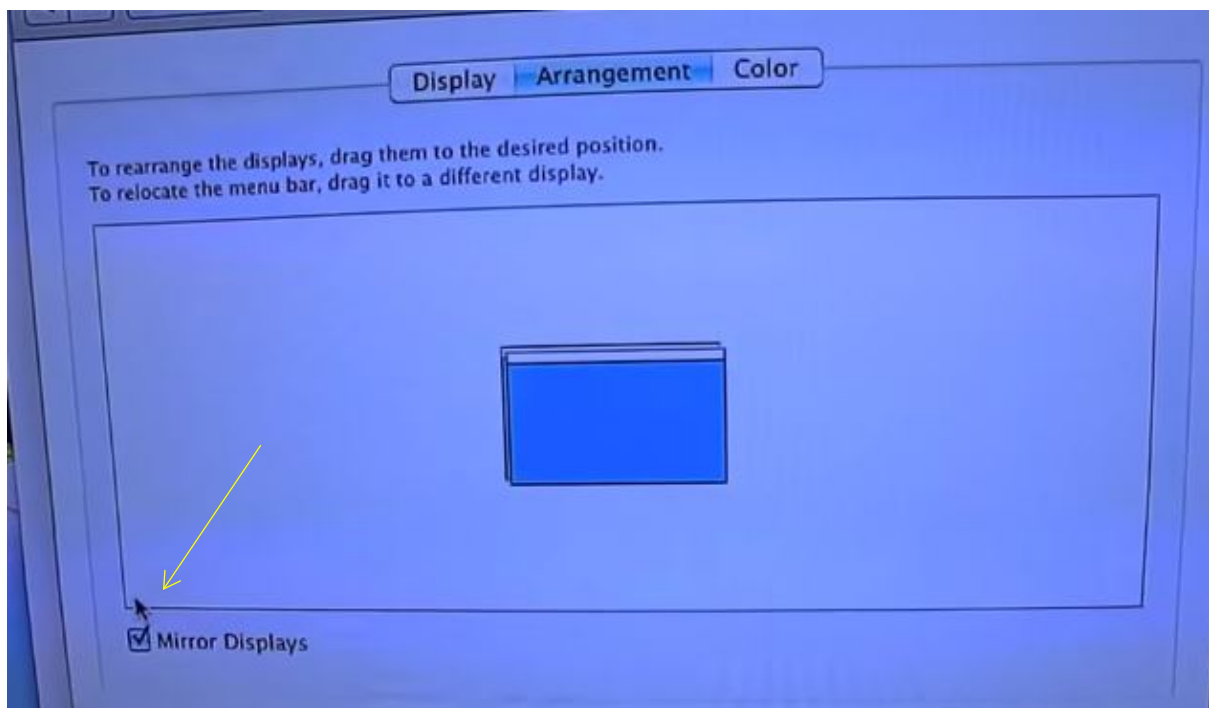

Fig. 15

Return to System Preferences and Select Sound as per fig. 16 following



Fig. 16

The Samsung TV should appear in the Output tab for selection. Change your selection from Internal Speakers to Samsung TV.

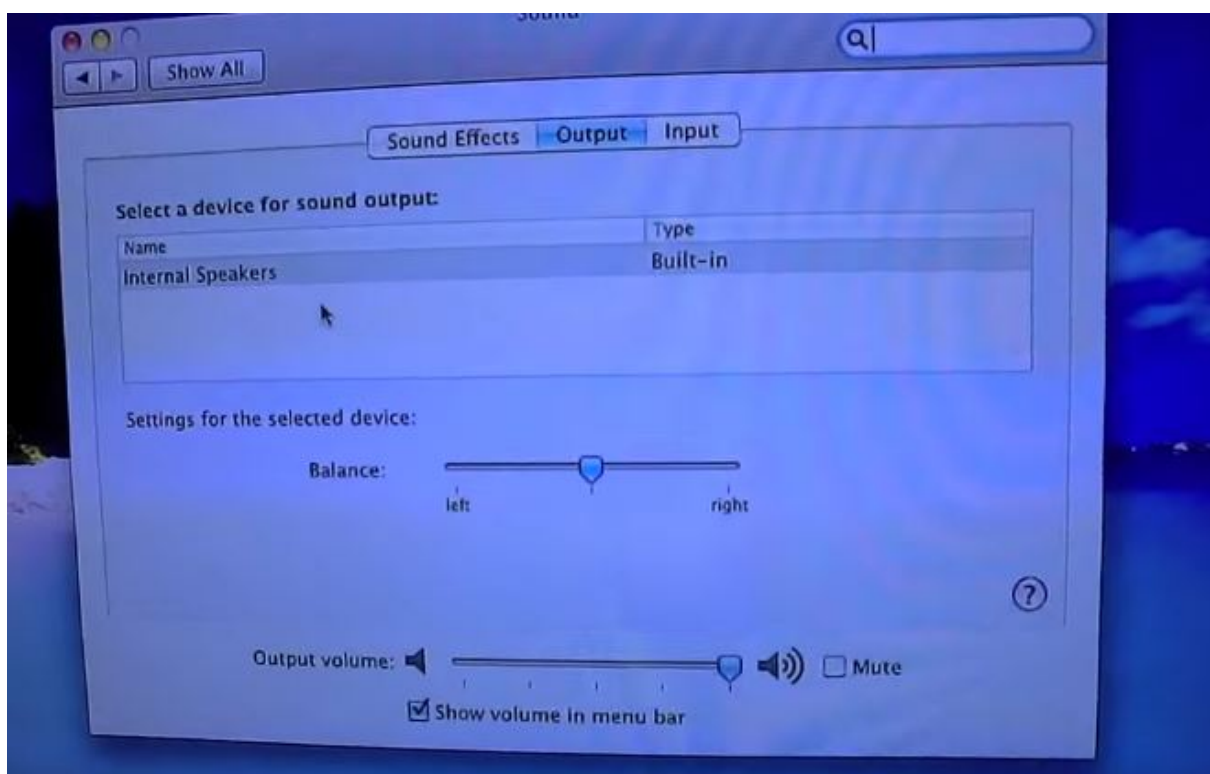

SUMMARY - Checklist Steps to play an Audio CD or Video DVD

Manual Page Ref.

1. Turn on TV using TV remote (or DVD Remote)	3
2. Turn on disc player using DVD remote	8
3. Turn on Soundbar using Soundbar remote	5
4. Open tray by pushing Eject key on Remote (or front panel of disc player )	
5. Insert Disc and close tray	
6. Check that the TV auto-detects the disc player and defaults the DVD play menu. If necessary, use the Source button on the remote and select HDMI1	6
7. If playing an audio CD, use the TV display to select track for playing. If using a DVD use the DVD remote to select from the disc menu displayed on the TV.	

SUMMARY - Checklist Steps to Display Laptop Content

Manual Page Ref.

Place laptop on shelf and connect power (if required)	
Connect either HDMI or VGA cables	11
If you are using VGA , also connect the mini audio plug into the headset socket of your laptop	11
Turn on TV using TV Remote (or DVD remote)	3
The TV should auto-detect the laptop connection, but to be sure you can use the Source button on the TV remote and select HDMI2 for VGA or HDMI3 for HDMI video.	4
Change the Display Mode on Laptop to Duplicate Content onto the TV Screen	12
If using audio, ensure the Soundbar is turned on and that the laptop speakers are set to at least 75% volume. Adjustments can be made to the laptop volume by clicking the loudspeaker icon at the bottom right of the laptop screen.	5